

Full bore all welded ball valve

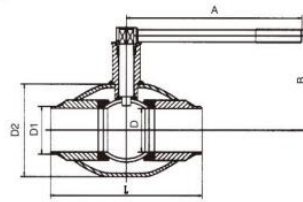

выбрать		Расследование	DN	А	Б	л	Д	Д1	Д2
DN15	129	90	210	15	22	43			
DN20	159	103	230	20	28	48			
DN25	159	107	260	25	34	60			
DN32	230	120	260	32	42	76			
DN40	230	126	300	40	48	89			
DN50	300	177	300	50	57	114			
DN65	300	186	300	65	76	140			
DN80	400	210	300	80	89	165			
DN100	400	214	325	100	108	216			
DN125	450	220	350	125	133	219			
DN150	450	280	400	150	159	355			
DN200	252	500	530	200	219	356			
DN250	236	500	550	250	274	457			
DN300	331	600	650	300	324	508			
DN350	331	600	762	337	377	550			
DN400	360	700	840	387	426	660			
Dn500	413	800	1010	489	530	813			
DN600	433	900	1140	591	630	1016			
DN700	433	900	1346	686	720	1130			
DN800	433	900	1524	781	820	1245			
DN900	433	900	1727	874	920	1385			
DN1000	550	900	1900	976	1020	1576			
DN1100	550	900	2000	1020	1120	1700			

Full bore all welded ball valve

DN1200	550	900	2100	1166	1220	2100
DN1400	550	900	2300	1360	1420	2281